

INSTALLATION INSTRUCTIONS

69-8702TP

LEXUS

2007-11 GS350

V6-3.5L

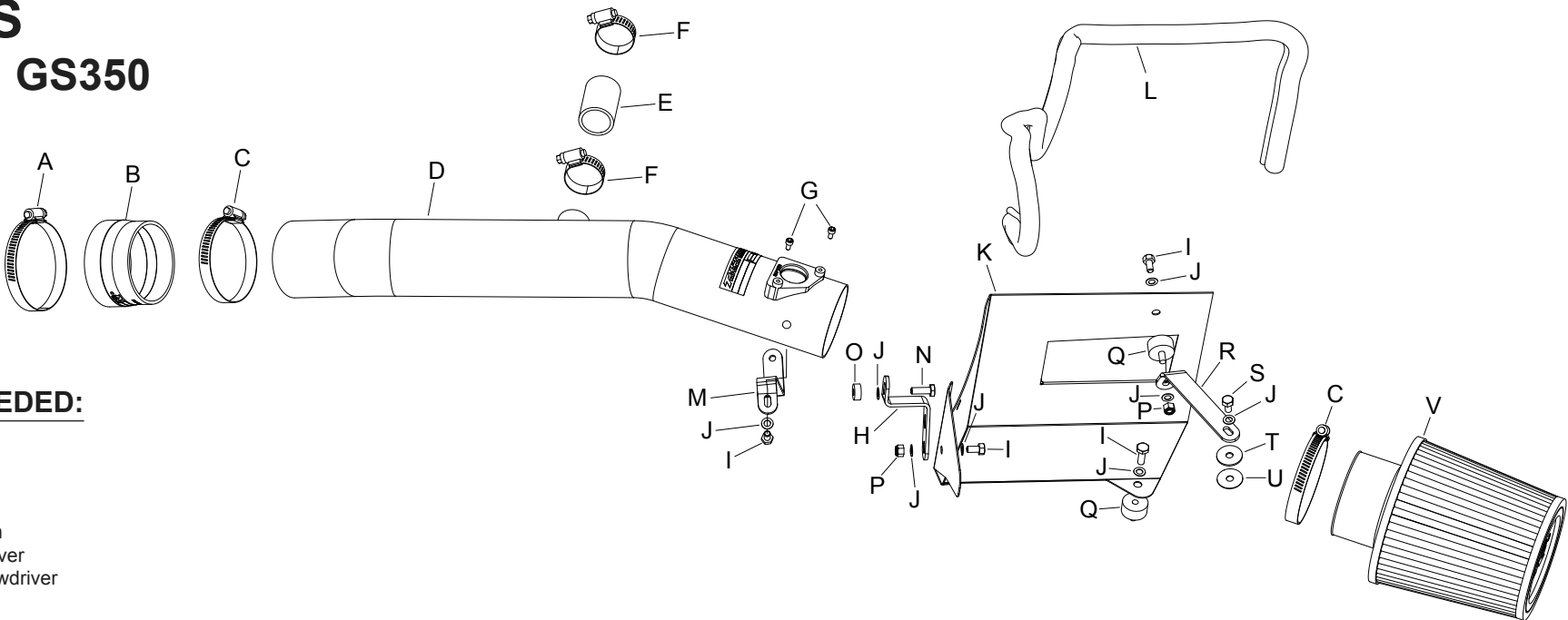

TOOLS NEEDED:

- ratchet
- extension
- 10mm socket
- 10mm wrench
- 3mm allen wrench
- flat head screwdriver
- phillips head screwdriver
- pliers

PARTS LIST:

| Description | Qty. | Part # | Description | Qty. | Part # | Description | Qty. | Part # |
|----------------------------------|------|---------|-------------------------------|------|--------|----------------------------------|------|---------|
| A HOSE CLAMP #44 | 1 | 08560 | I BOLT; M6-1.0 X 12MM SS | 4 | 07727 | Q STUD; RUBBER MNT | 2 | 070228 |
| B HOSE; 3" ID 3-1/8ID X 2"L TPRD | 1 | 084031 | J WASHER; 6MM WAVE SS | 8 | 08277 | R BRACKET; "L" | 1 | 020001 |
| C HOSE CLAMP #48 | 2 | 08601 | K HEAT SHIELD | 1 | 07341 | S BOLT; M6-1.0 X 16MM SS | 1 | 07703 |
| D TUBE 3" OD | 1 | 27513TP | L EDGE TRIM; 39" L | 1 | 102496 | T WASHER; 1" D X 1/4 HOLE FENDER | 1 | 08160 |
| E HOSE; 1-1/8" ID X 2"L | 1 | 084074 | M BRACKET; "Z" | 1 | 070992 | U WASHER; 1" X 3.00 RUBBER | 1 | 21685 |
| F HOSE CLAMP #16 | 2 | 08413 | N BOLT; M6-1.0 X 20MM SS | 1 | 07795 | V AIR FILTER | 1 | RU-4990 |
| G BOLT; M4-0.07 8MM SS | 2 | 07733 | O SPACER; .625" OD X .250" ID | 1 | 06555 | | | |
| H BRACKET; "Z" | 1 | 020003 | P NUT; 6MM NYLOCK | 2 | 07512 | | | |

NOTE: FAILURE TO FOLLOW INSTALLATION INSTRUCTIONS AND NOT USING THE PROVIDED HARDWARE
MAY DAMAGE THE INTAKE TUBE, THROTTLE BODY AND ENGINE.

TO START:

1. Turn off the ignition and disconnect the negative battery cable.
- NOTE: Disconnecting the negative battery cable erases pre-programmed electronic memories. Write down all memory settings before disconnecting the negative battery cable. Some radios will require an anti-theft code to be entered after the battery is reconnected. The anti-theft code is typically supplied with your owner's manual. In the event your vehicles anti-theft code cannot be recovered, contact an authorized dealership to obtain your vehicles anti-theft code.



2. Pull firmly up on the engine cover and remove the cover from the engine as shown.



3. Depress the center locking button to release seven core support fasteners.



4. Remove the seven fasteners, then remove the cover from the core support.

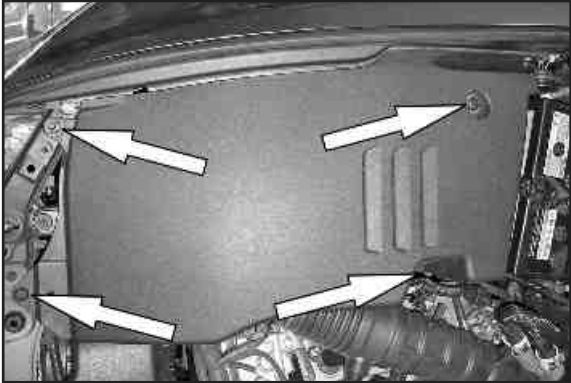

5. Depress the center locking button on the two air filter cover fasteners, remove the two fasteners and unscrew plastic screw shown. Then remove the cover from the vehicle.



6. Remove the bolt that secures the fresh air supply to the core support.



7. Remove the fresh air supply from the core support as shown.



8. Disconnect the mass air sensor electrical connection and unhook the wiring harness from the air box.



9. Unhook the crank case vent hose from the fitting in the stock intake tube.

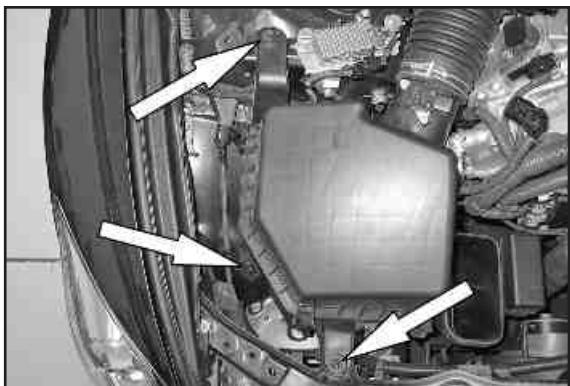

10. Loosen and remove the three air box mounting bolts shown.



11. Loosen the hose clamp that secures the stock intake tube to the throttle body.



12. Remove the complete intake assembly.
NOTE: Unhook the vacuum lines clipped onto the intake tube.
NOTE: K&N® recommends that customers do not discard factory air intake.



13. Install the edge trim onto the heat shield as shown.



14. Install the rubber mounted stud onto the heat shield as shown.



15. Install the "L" bracket (020001) onto the rubber mounted stud as shown.

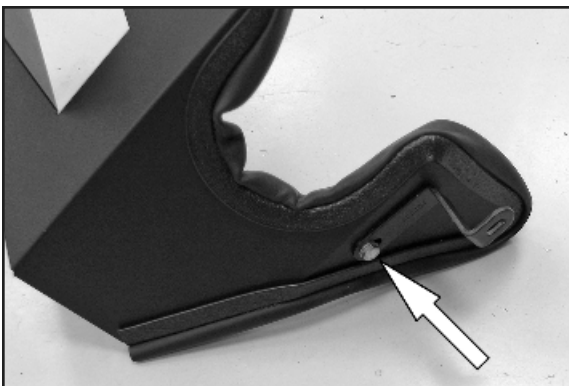

16. Install the "Z" bracket (020003) onto the heat shield as shown.

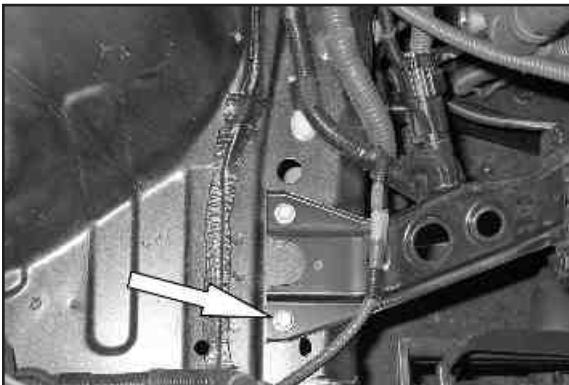

17. Remove the relay bracket mounting bolt shown.

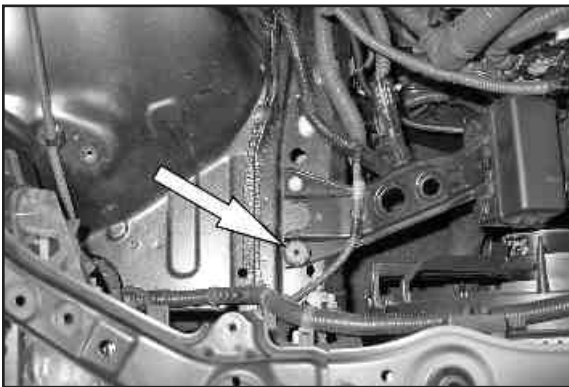

18. Install the rubber mounted stud into the relay mounting bracket as shown.

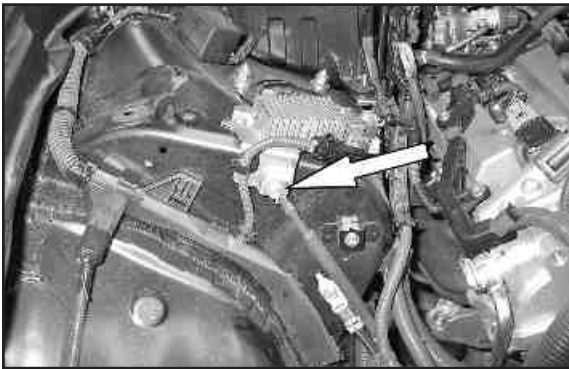

19. Remove the ground strap bolt shown.

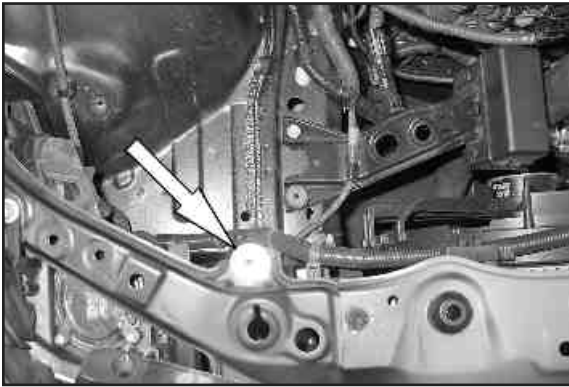

20. Install the fender washer and rubber washer onto the air box mounting point on the core support as shown.



21. Set the heat shield into position and align with the rubber mounted stud, fender washer, and the ground strap bracket. Secure with provided hardware.
NOTE: Be sure to use the provide spacer on top of the ground strap.



22. Remove the screws that secure the mass air sensor into the stock air filter housing and then remove the mass air sensor.



23. Install the mass air sensor into the K&N® intake tube with provided bolts.



24. Remove the crank case vent chamber from the stock intake tube as shown.



25. Install the silicone hose onto the K&N® intake tube crank case vent as shown and secure with the hose clamp, then install the factory crank case vent chamber into the silicone hose and secure with the hose clamp as shown.



26. Install the "Z" (070992) onto the K&N® intake tube as shown.
NOTE: the twist side of the bracket should be bolted to the tube.



27. Install the silicone hose onto the throttle body and secure with the provided hose clamp.



28. Remove the valve cover mounting bolt shown.



29. Install the K&N® intake tube into the silicone hose at the throttle body and align the bracket to the valve cover, secure with the factory valve cover bolt and hose clamp.



30. Reconnect the crank case vent hose to the fitting and secure with the factory hose clamp.



31. Using a small screw driver, remove the mass air sensor plastic elbow cover and then reconnect the mass air sensor electrical connection.



32. Install the K&N® air filter onto the intake tube and then tighten the hose clamp.
NOTE: Drycharger® air filter wrap; part # RX-4990DK is available to purchase separately. To learn more about Drycharger® filter wraps or look up color availability please visit <http://www.knfilters.com>®.

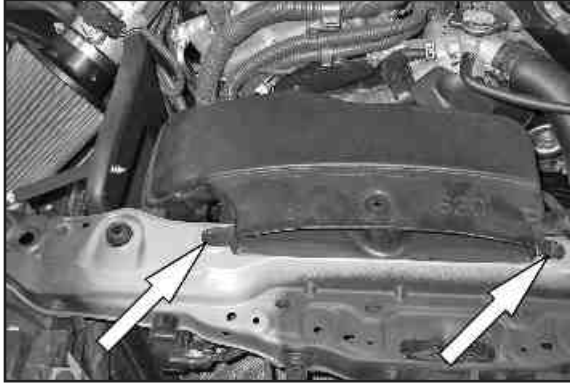

33. Reinstall the fresh air supply and secure with the factory bolt removed in step #6.



34. Reinstall the air filter cover and secure with the factory retainers.



35. Reinstall the front cover and secure with the factory retainers.



36. Reinstall the engine cover onto the top of the engine.

37. Reconnect the vehicle's negative battery cable. Double check to make sure everything is tight and properly positioned before starting the vehicle.

38. It will be necessary for all K&N® intake kits to be checked periodically for realignment, clearance and tightening of all connections. Failure to follow the above instructions or proper maintenance may void warranty.

ROAD TESTING:

1. Start the engine with the transmission in neutral or park, and the parking brake engaged. Listen for air leaks or odd noises. For air leaks secure hoses and connections. For odd noises, find cause and repair before proceeding. This kit will function identically to the factory system except for being louder and much more responsive.

2. Test drive the vehicle. Listen for odd noises or rattles and fix as necessary.

3. If road test is fine, you can now enjoy the added power and performance from your kit.

4. K&N Engineering, Inc., requires cleaning the intake system's air filter element every 100,000 miles. When used in dusty or off-road environments, our filters will require cleaning more often. We recommend that you visually inspect your filter once every 25,000 miles to determine if the screen is still visible. When the screen is no longer visible some place on the filter element, it is time to clean it. To clean and re-oil, purchase our filter Recharger® service kit, part number 99-5050 or 99-5000 and follow the easy instructions.

LEGAL IN CALIFORNIA ONLY FOR RACING VEHICLES
WHICH MAY NEVER BE USED, REGISTERED
OR LICENSED FOR USE UPON A HIGHWAY.

See knfilters.com for CARB status on each part for a specific vehicle