



INTAKE SYSTEMS FOR VEHICLES LISTED ARE 50
STATE LEGAL. SEE KNFILTERS.COM FOR CARB
STATUS ON EACH PART FOR A SPECIFIC VEHICLE.

INSTALLATION INSTRUCTIONS

57-3000
CHEVROLET / GMC
2005-06 Silverado HD
2005-06 Sierra HD
2007 Silverado HD Classic
2007 Sierra HD Classic
V8-6.6L Turbo Diesel

NOTE: This kit was not designed
to fit vehicles with a body lift.

TOOLS NEEDED:

- Ratchet
- Extension
- 10mm Socket
- 10mm Wrench
- Flat Blade Screwdriver
- 2.5mm Allen Wrench
- 3.0mm Allen Wrench
- T20 Torx Wrench

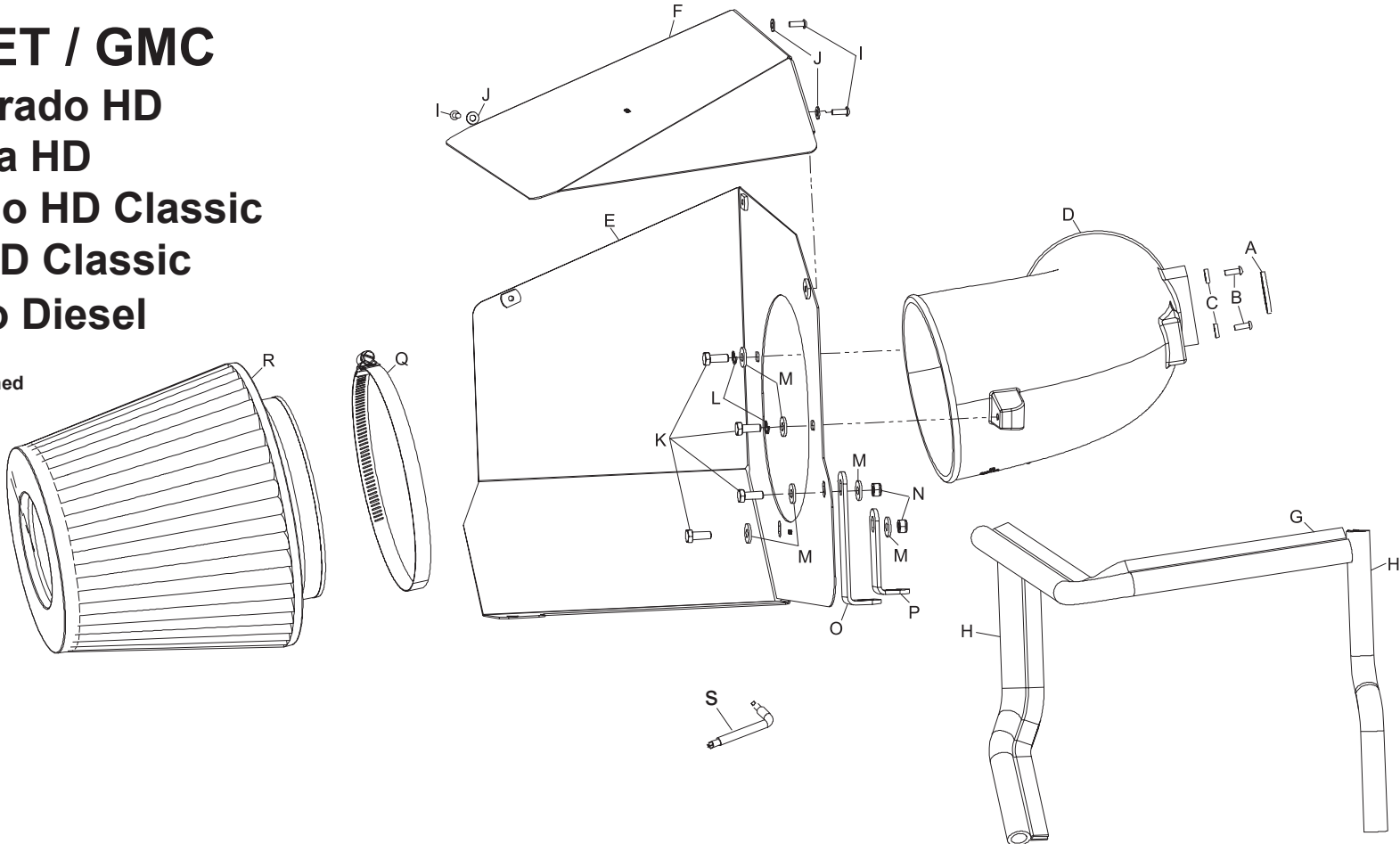

PARTS LIST:

Description	Qty.	Part #	Description	Qty.	Part #	Description	Qty.	Part #
A Gasket	1	09009	H Edge Trim 11"	2	102468	O Bracket; Long "L"	1	070952
B Bolt; M4-.7 x 12MM, B/H/A	2	07726	I Bolt; M5-0.8 x 12MM B/H/A	3	07734	P Bracket; Short "L"	1	07805
C Spacer; .437"OD x .2"ID x .115"	2	06503	J Washer; 5MM Flat	3	08212	Q Hose Clamp #104	1	08697
D Intake Tube	1	087192	K Bolt; M6-1.00 x 16MM	4	07703	R Air Filter	1	RC-5179
E Heat Shield	1	07672	L Washer; 1/4" Split	2	08198	S Torx Wrench	1	69801
F Heat Shield	1	07673	M Washer; 5/8"OD x 1/4"ID Flat	6	08275			
G Edge Trim 20"	1	102476	N Nut; 6MM Nylock	2	07553			

NOTE: FAILURE TO FOLLOW INSTALLATION INSTRUCTIONS AND NOT USING THE PROVIDED HARDWARE
MAY DAMAGE THE INTAKE TUBE, THROTTLE BODY AND ENGINE.

TO START:

1. Turn off the ignition and disconnect the negative
battery cable.
NOTE: Disconnecting the negative battery cable
erases pre-programmed electronic memories.
Write down all memory settings before
disconnecting the negative battery cable. Some
radios will require an anti-theft code to be
entered after the battery is reconnected. The
anti-theft code is typically supplied with your
owner's manual. In the event your vehicles'
anti-theft code cannot be recovered, contact an
authorized dealership to obtain your vehicles
anti-theft code.



2. Depress the locking tab on the mass air sensor
electrical connector, and then disconnect the
electrical connection as shown.



3. Loosen the hose clamps which secure the air
filter housing to the stock intake tube.



4. Lift up the air filter housing to release it form the
mounting grommets, and then remove the air filter
housing from the vehicle as shown.
NOTE: K&N recommends that you do not
discard your factory air intake.

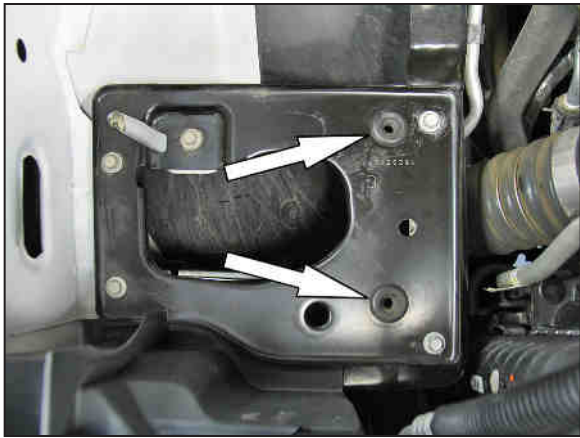

5. Remove the two mounting grommets shown
from the mounting plate.



6. Remove the three bolts shown which secure the
mounting plate.



7. Using the “TORX” T20 wrench provided, remove the two bolts, which secure the mass air sensor to the air filter housing and then remove the mass air sensor.



8. Remove the air filter restriction gauge and stock grommet from the air filter housing as shown.



9. Install new gasket onto mass air sensor as shown with stickyside towards mass air sensor.



10. Install the two spacers under the mass air sensor then attach the mass air sensor to the K&N® intake tube with the provided hardware.



11. Install the factory grommet and filter restriction gauge into the K&N® intake tube as shown.

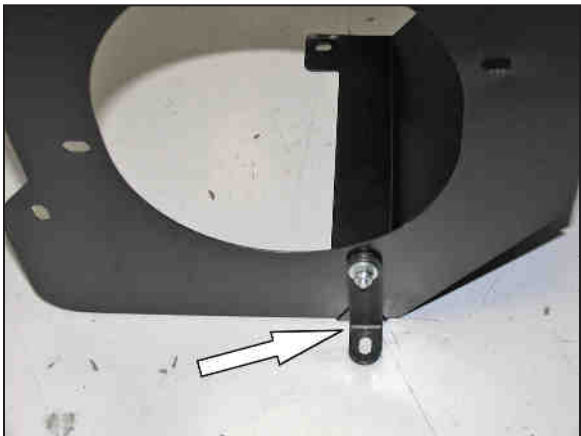

12. Install the “L” bracket (07805) onto the heat shield as shown with the provided hardware as shown.



13. Install the “L” bracket (070952) onto the heat shield as shown with the provided hardware as shown.



14. Install the edge trim onto the heat shield as shown.
NOTE: Some trimming of the edge trim will be necessary.



15. Install the edge trim onto the heat shields as shown.
NOTE: Some trimming of the edge trim will be necessary.



16. Install the heat shield onto the air box mounting plate and secure with the factory bolts removed in step #6.



17. Set the K&N® filter into the heat shield as shown.



18. Install the K&N® intake tube into the heat shield and into the stock intake tube, then secure the K&N® intake tube to the heat shield with the hardware provided and hose clamp at the stock intake tube.



19. Install the K&N® filter onto the K&N® intake tube and secure with the provided hose clamp.



20. Install the edge trim onto the heat shield lid as shown.



21. Install the heat shield lid onto the heat shield and secure with the three 5mm button head allen bolts provided.

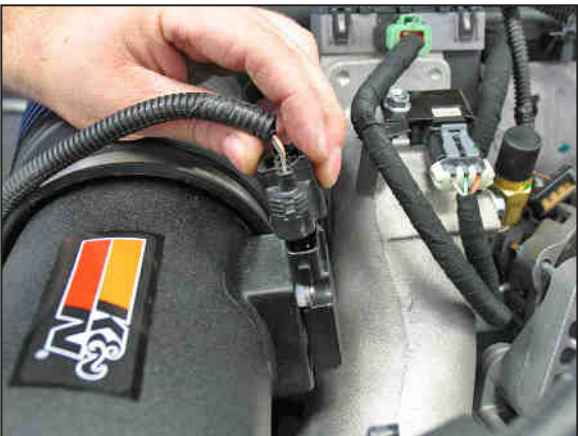

22. Reconnect the mass air sensor electrical connection.



23. Reconnect the vehicle's negative battery cable. Double check to make sure everything is tight and properly positioned before starting the vehicle.

24. The C.A.R.B. exemption sticker, (attached), must be visible under the hood so that an emissions inspector can see it when the vehicle is required to be tested for emissions. California requires testing every two years, other states may vary.

25. **NOTE:** Most General Motors vehicles have the Vehicle Emissions Certification Information (VECI) label affixed to the air filter box. In order to be compliant with California emissions laws, the label **MUST** remain in the engine compartment. If the Vehicle Emission Control Information label is removed during modification, a new replacement label must be obtained and installed in a readily visible position in the engine compartment. The label shall not be affixed to any equipment which is easily detached from the vehicle. We recommend that the label is affixed to the underside of the hood adjacent to the hood latch. The label is Vehicle Identification Number dependent and can be ordered from the vehicle dealership. In order to receive the proper decal please bring your VIN with you. Failure to have the VECI under the hood may result in failure of a pre-registration smog test.

26. It will be necessary for all K&N® high flow intake systems to be checked periodically for realignment, clearance and tightening of all connections. Failure to follow the above instructions or proper maintenance may void warranty.

ROAD TESTING:

1. Start the engine with the transmission in neutral or park, and the parking brake engaged. Listen for air leaks or odd noises. For air leaks secure hoses and connections. For odd noises, find cause and repair before proceeding. This kit will function identically to the factory system except for being louder and much more responsive.
2. Test drive the vehicle. Listen for odd noises or rattles and fix as necessary.
3. If road test is fine, you can now enjoy the added power and performance from your kit.
4. K&N Engineering, Inc., requires cleaning the intake system's air filter element every 100,000 miles. When used in dusty or off-road environments, our filters will require cleaning more often. We recommend that you visually inspect your filter once every 25,000 miles to determine if the screen is still visible. When the screen is no longer visible some place on the filter element, it is time to clean it. To clean and re-oil, purchase our filter Recharger® service kit, part number 99-5050 or 99-5000 and follow the easy instructions.

IMPORTANT:
Service air filter according to the K&N cleaning instructions (99-5050) when the indicator on the restriction gauge reaches the last two lines in the green. Do not run the vehicle with the yellow indicator in the red, as damage to the air filter and or engine could result.

INTAKE SYSTEMS FOR VEHICLES LISTED ARE 50 STATE LEGAL. SEE KNFILTERS.COM FOR CARB STATUS ON EACH PART FOR A SPECIFIC VEHICLE.